

ALLOW ROOF SLAB
TO REST ON TO
BEARING WALL
CONCRETE

FORM PANELS c/w
INSERT WEBS— CUT TO
SUIT ROOF
CONNECTION—
ADDITIONAL FORM
SUPPORT AS REQUIRED

FIBER BOARD SUBSTRATE
w/ ROOF MEMBRANE
ON 3 1/2" (89mm) RIGID
INSULATION

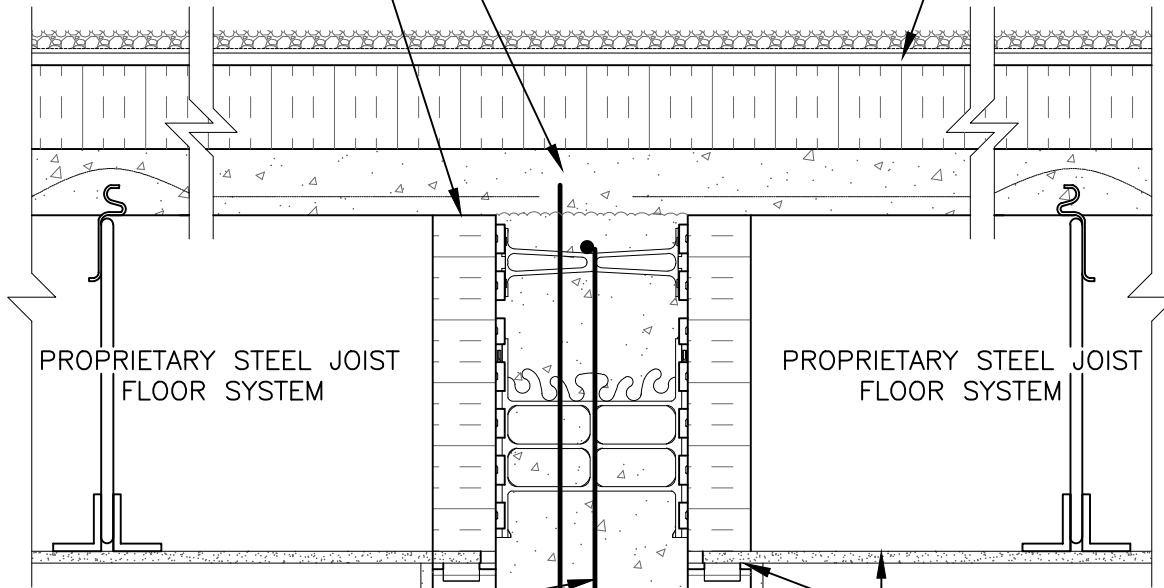

PROPRIETARY STEEL JOIST
FLOOR SYSTEM

PROPRIETARY STEEL JOIST
FLOOR SYSTEM

HORIZ/VERT
REINFORCEMENT AS
PER CODE OR AS
SPECIFIED

WET SET DOWELS TO
MATCH VERTICAL
REINFORCEMENT
BETWEEN POUR OR
AS SPECIFIED

NUDURA 8" (203mm)
STANDARD FORM UNIT

CEILING FINISH AS PER STEEL
JOIST MANUFACTURERS
SPECIFICATION (NOTE: WHERE
GYPSUM BOARD IS REQUIRED TO
COMPLETE FIRE RATED ASSEMBLY,
EPS FOAM KERF CUT TO ENABLE
CEILING FINISH TO PROVIDE
THERMAL BARRIER CONTACT TO
CONCRETE)

1/2" (13mm) GYPSUM BOARD

The architecture, engineering, and design of the project using the Nudura products are the responsibility of the project's design professional. All products and systems must comply with local building codes and standards. This detail is for general information and guidance only and Nudura specifically disclaims any liability for the use of this detail. The project design professional determines, in its sole discretion, whether this detail or a functionally equivalent detail is best suited for the project. This detail is subject to change without notice. Contact Nudura to ensure you have the most recent version.

Non-Combustible Construction

Detail: Nudura 8" (203mm) Form Unit, Steel Joist Roof System,
Non-Bearing Demising Wall

File Name:

Drawn by: KS

Scale: 1 : 8

Date: 12/10/2021

G8B04

Nudura

Nudura Technical Support: 866-468-6299
International: +1 705-726-9499

tremcocpg.com

TREMCO

Construction Products Group