

HORIZ/VERT
REINFORCEMENT AS PER
CODE OR AS SPECIFIED

NUDURA 8" (203mm)
STANDARD FORM UNIT

HOOK REINFORCEMENT
AS PER CODE OR AS
SPECIFIED

COMPRESSIBLE VOID
FORM AS SPECIFIED
BETWEEN PILES

CONCRETE PILES
AS PER CODE

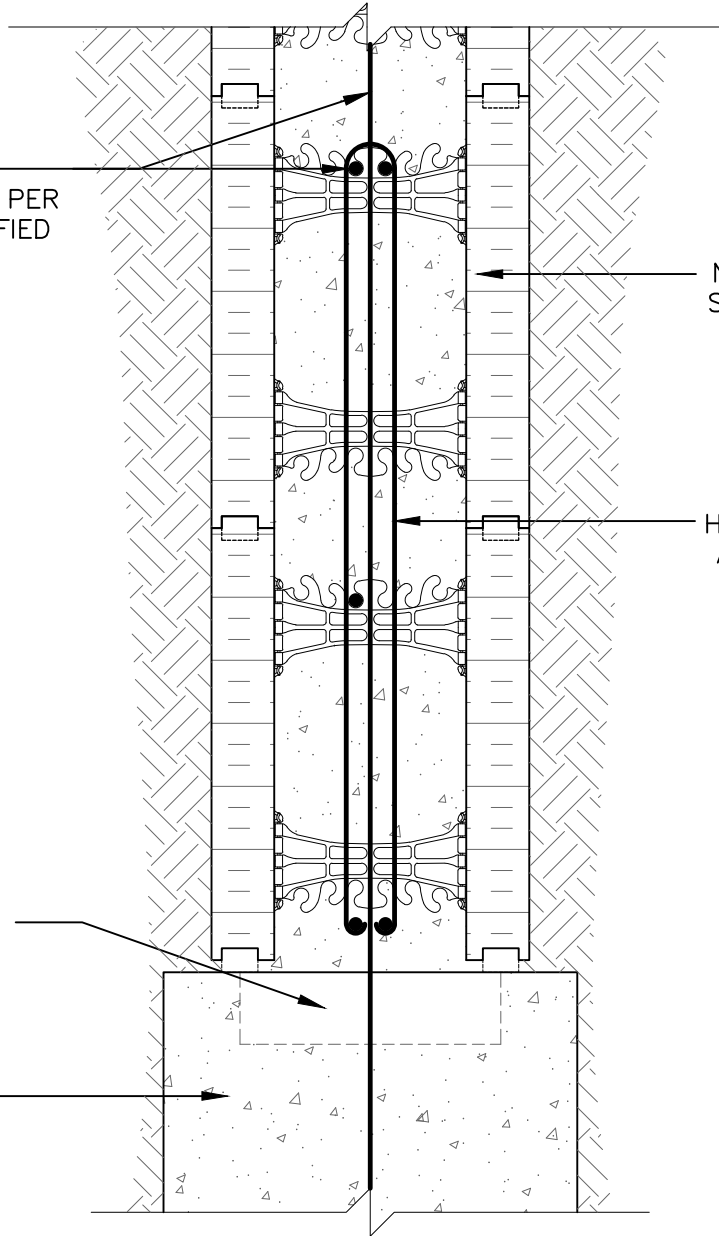

DISCLAIMER NOTICE:
SPECIFIC INFORMATION
REQUIRED FOR COMPLIANCE
WITH LOCAL CODES IS THE
RESPONSIBILITY OF THE
DESIGNER

The architecture, engineering, and design of the project using the Nudura products are the responsibility of the project's design professional. All products and systems must comply with local building codes and standards. This detail is for general information and guidance only and Nudura specifically disclaims any liability for the use of this detail. The project design professional determines, in its sole discretion, whether this detail or a functionally equivalent detail is best suited for the project. This detail is subject to change without notice. Contact Nudura to ensure you have the most recent version.

Below Grade Construction

Detail: Nudura 8" (203mm) Form Unit Stem Wall On Piles

File Name:



Drawn by: T.V

Scale: 1 : 8

Date: 11/30/2021

B8C07

Nudura Technical Support: 866-468-6299
International: +1 705-726-9499

tremcocpg.com

