

# TYPICAL DETAILS C-10

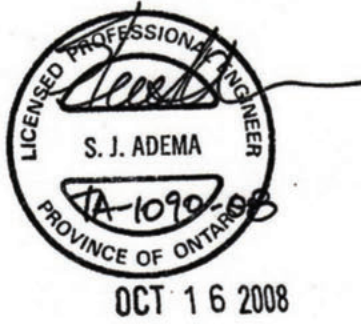
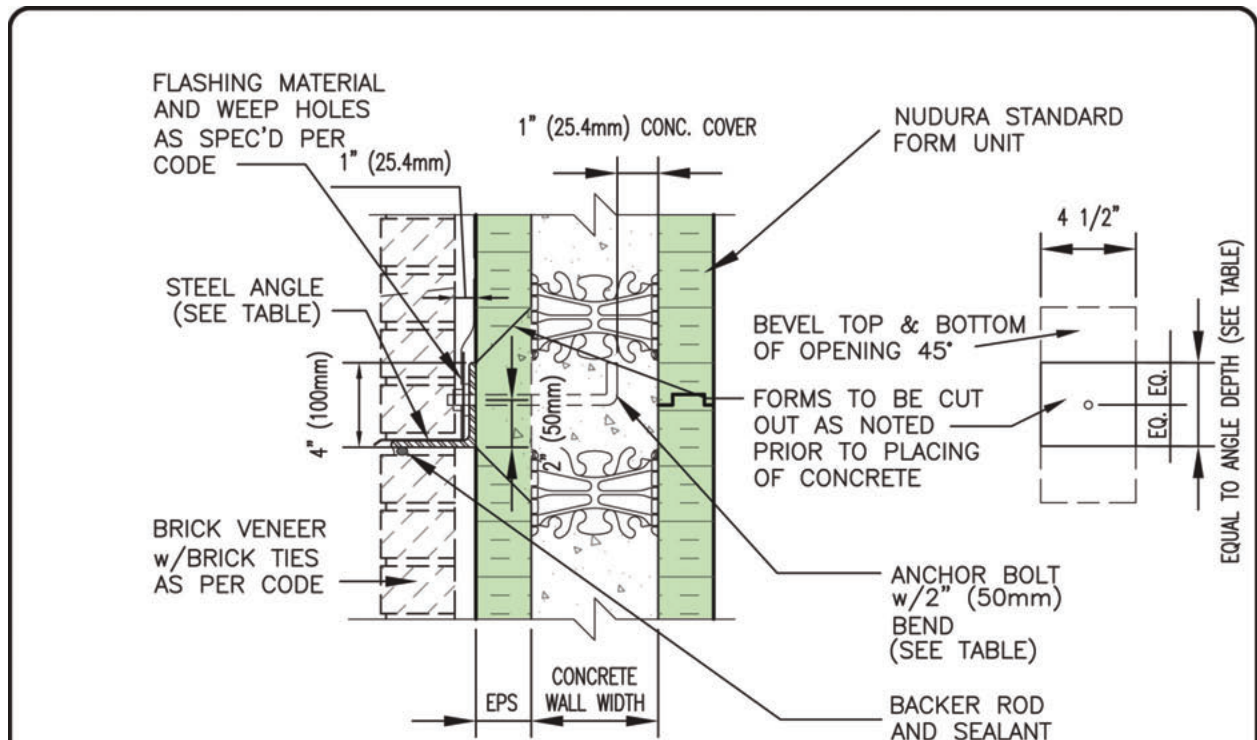

|                | HEIGHT OF SUPPORTED BRICK ABOVE ANGLE |                                       |
|----------------|---------------------------------------|---------------------------------------|
|                | 10'-0" (3050mm)                       | 20'-0" (6100mm)                       |
| ANGLE SIZE     | L4" x 4"x 1/4"<br>(L102 x 102 x 6.35) | L4" x 4"x 1/4"<br>(L102 x 102 x 6.35) |
| ANCHOR SIZE    | 1/2" DIA.<br>(12.5mm DIA.)            | 1/2" DIA.<br>(12.5mm DIA.)            |
| ANCHOR SPACING | 24"<br>(610mm)                        | 16"<br>(406mm)                        |

**NOTES:**

- 1 ASSUMES BRICK INSTALLATION IN ACCORDANCE WITH APPLICABLE CODES.
- 2 MIN. STEEL  $F_y=43.5$  ksi (300 MPa) YIELD STRENGTH FOR ANGLES
- 3 ANGLES AND BOLTS TO BE GALVANIZED OR STAINLESS STEEL TO MEET THE REQUIREMENT OF TABLE 5.1 OF A370-04 (CONNECTIONS FOR MASONRY, OR EQUIVALENT STANDARD)

DISCLAIMER NOTICE:  
SPECIFIC INFORMATION  
REQUIRED FOR COMPLIANCE  
WITH LOCAL CODES IS THE  
RESPONSIBILITY OF THE  
DESIGNER

A6B03

BRICK SHELF ANGLE  
BACK OF ANGLE FLUSH  
WITH E.P.S. EXTERIOR  
(MULTI-STORY APPLICATION)  
PRE-INSTALLATION MOUNT

|                        |                        |
|------------------------|------------------------|
| REV. NO.<br>002 TV     | DWG. NO.<br>C-10       |
| REV. DATE:<br>JAN 2006 |                        |
| DRAWN BY<br>J.N / N.L. | SCALE:<br>1 1/2"=1'-0" |