

HORIZ/VERT
REINFORCEMENT AS PER
CODE OR AS SPECIFIED

NUDURA 10" (254mm)
STANDARD FORM UNIT

HOOK REINFORCEMENT
AS PER CODE OR AS
SPECIFIED

COMPRESSIBLE VOID
FORM AS SPECIFIED
BETWEEN PILES

CONCRETE PILES
AS PER CODE

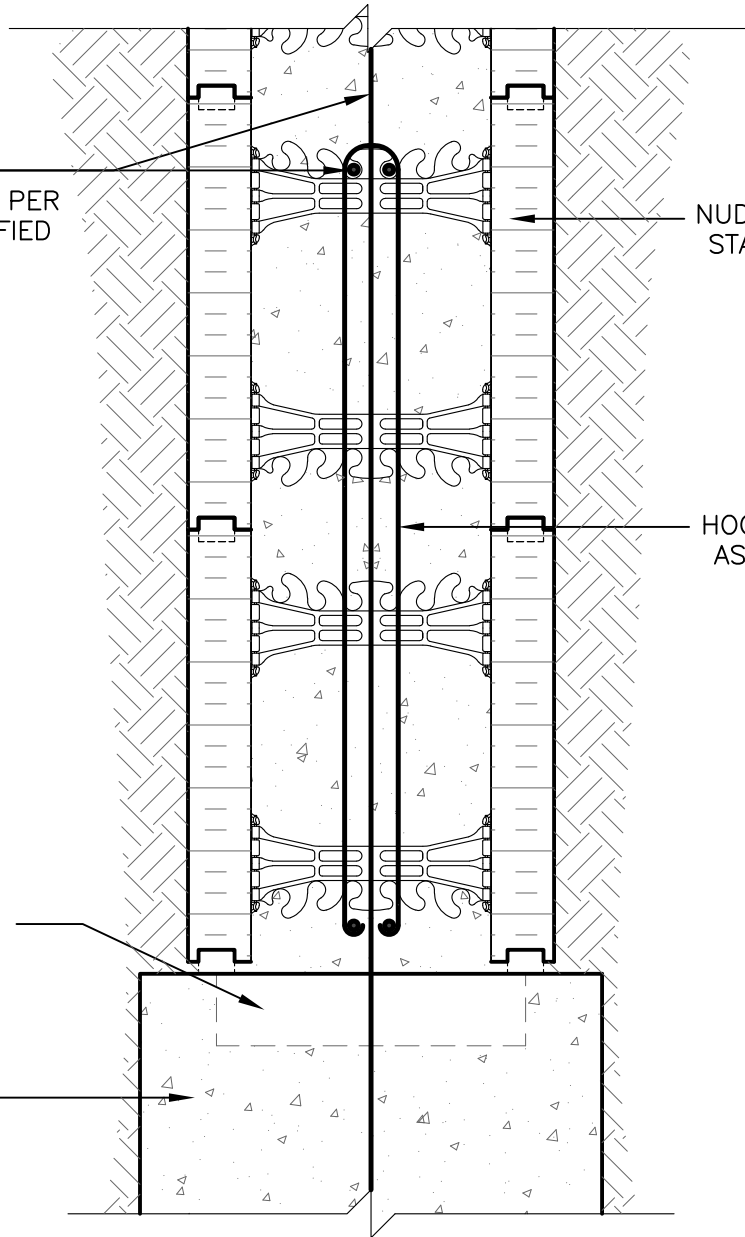

DISCLAIMER NOTICE:
SPECIFIC INFORMATION
REQUIRED FOR COMPLIANCE
WITH LOCAL CODES IS THE
RESPONSIBILITY OF THE
DESIGNER



NUDURA

INTEGRATED BUILDING TECHNOLOGY

Building Value.

NUDURA 10" (254mm) FORM UNIT
STEM WALL ON PILES

REV. NO.
003 KS

REV. DATE:
FEB 2010

DRAWN BY:
T. VAN CLIEAF

DWG NO.

B10C03

SCALE:

1 : 8