

**DISCLAIMER NOTICE:**  
 SPECIFIC INFORMATION  
 REQUIRED FOR COMPLIANCE  
 WITH LOCAL CODES IS THE  
 RESPONSIBILITY OF THE  
 DESIGNER

PRE-ENGINEERED ROOF TRUSSES  
 OR RAFTERS AS PER CODE

EXTERIOR FINISH AS SPECIFIED

1/2" (13mm) GYPSUM BOARD

NUDURA 6" (152mm) FORM  
 HORIZ/VERT REINFORCING AS PER  
 CODE OR AS SPECIFIED IN  
 APPENDIX 'D' FOR ABOVE GRADE

1/2" (13mm) GYPSUM BOARD

MINIMUM 6" (150mm) BELOW GRADE OF  
 ACRYLIC PARGE COAT

GRADE MINIMUM 2% SLOPE

NUDURA DAMPROOFING/  
 WATERPROOFING MEMBRANE

1/2" (13mm) GYPSUM BOARD

EXISTING SOIL

BACKFILL SOIL AS PER CODE

NUDURA 6" (152mm) FORM  
 HORIZ/VERT REINFORCING AS  
 PER CODE OR AS SPECIFIED IN  
 APPENDIX 'D' FOR BELOW GRADE

CONTINUOUS 4" (100mm)  
 ROUND PERFORATED DRAIN TILE  
 COVERED WITH 6" (150mm)  
 CRUSHED GRANULAR AS PER CODE

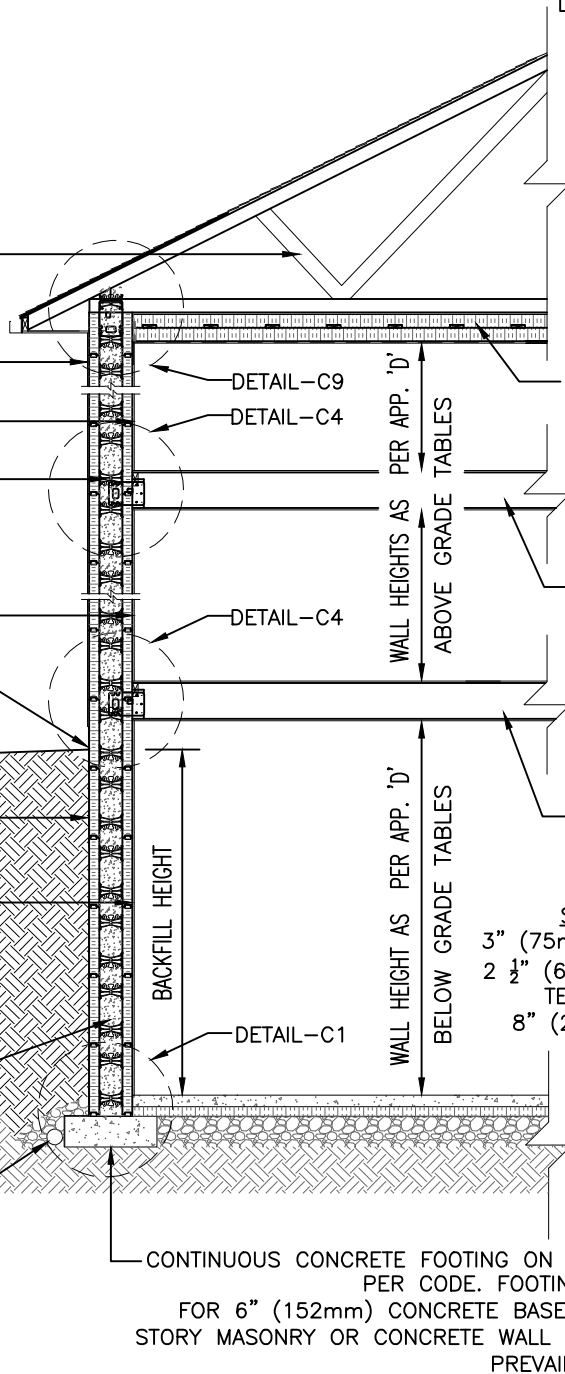

DETAIL-C9  
 DETAIL-C4  
 WALL HEIGHTS AS PER APP. 'D'  
 ABOVE GRADE TABLES

2 LAYERS OF NUDURA  
 CEILING TECHNOLOGY  
 (OPTIONAL) OR  
 CONVENTIONAL  
 INSULATION AS PER  
 CODE

WOOD FLOOR SYSTEM  
 AS SPECIFIED

DETAIL-C4  
 WALL HEIGHT AS PER APP. 'D'  
 BELOW GRADE TABLES

WOOD FLOOR SYSTEM  
 AS SPECIFIED

**SLAB ASSEMBLY**  
 3" (75mm) CONCRETE FLOOR  
 2 1/2" (64mm) NUDURA FLOOR  
 TECHNOLOGY (OPTIONAL)  
 8" (200mm) CLEAR STONE

CONTINUOUS CONCRETE FOOTING ON UNDISTURBED SOIL AS  
 PER CODE. FOOTING SIZE AS PER CODE  
 FOR 6" (152mm) CONCRETE BASEMENT WALL PLUS TWO  
 STORY MASONRY OR CONCRETE WALL (NON-BRICK FINISH &  
 PREVAILING SITE CONDITIONS)

\*NOTE: IN ADDITION TO FOOTING SIZE INDICATED BY CODE, ADD 1" (25.4mm) WIDTH TO STRIP FOOTING FOR EVERY  
 1'0" (305mm) OF CONCRETE WALL HEIGHT ABOVE 8'0" (2440mm) PER STORY

The architecture, engineering, and design of the project using the Nudura products are the responsibility of the project's design professional. All products and systems must comply with local building codes and standards. This detail is for general information and guidance only and Nudura specifically disclaims any liability for the use of this detail. The project design professional determines, in its sole discretion, whether this detail or a functionally equivalent detail is best suited for the project. This detail is subject to change without notice. Contact Nudura to ensure you have the most recent version.

**Typical Cross Sections**

 Nudura Technical Support: 866-468-6299 International: +1 705-726-9499	Detail: Building Section Basement 6" (152mm) Form Unit 2 Story 6" (152mm) Form Unit Non-Brick Finish		File Name:	 Construction Products Group
	Drawn by: J.N / N.L	Scale: NTS	Date: 10/28/2021	