

ALLOW ROOF SLAB  
TO REST ON TO  
BEARING WALL  
CONCRETE

FORM PANELS c/w  
INSERT WEBS— CUT TO  
SUIT ROOF  
CONNECTION—  
ADDITIONAL FORM  
SUPPORT AS REQUIRED

FIBER BOARD SUBSTRATE  
w/ ROOF MEMBRANE  
ON 3 1/2" (89mm) RIGID  
INSULATION

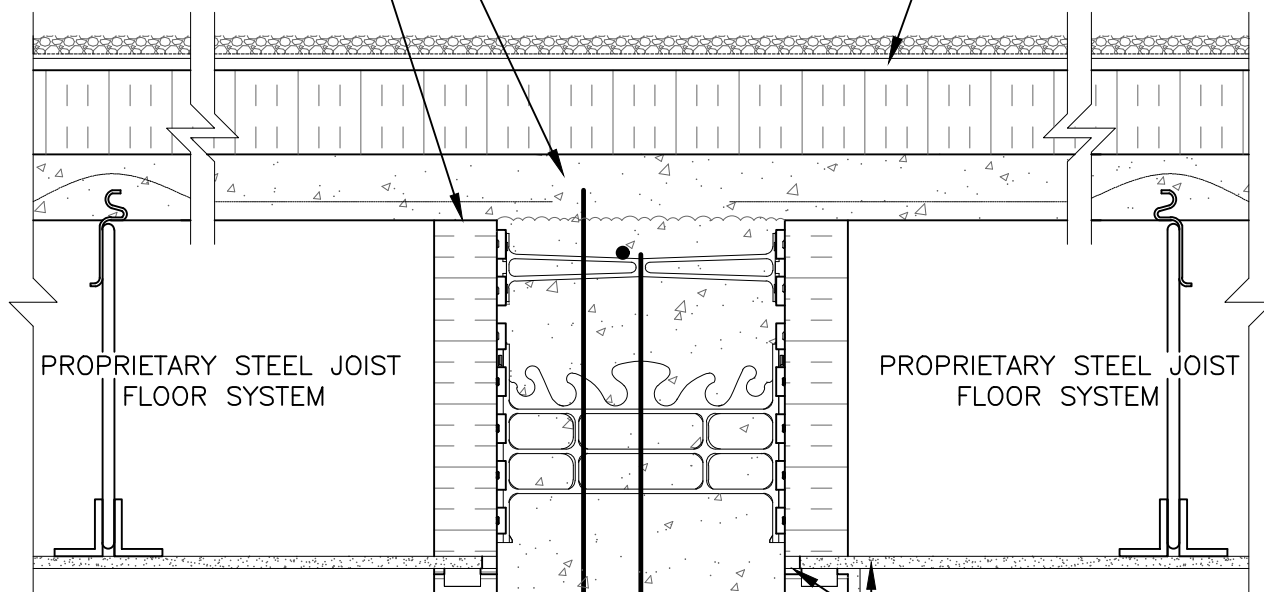

PROPRIETARY STEEL JOIST  
FLOOR SYSTEM

PROPRIETARY STEEL JOIST  
FLOOR SYSTEM

HORIZ/VERT  
REINFORCEMENT AS  
PER CODE OR AS  
SPECIFIED

WET SET DOWELS TO  
MATCH VERTICAL  
REINFORCEMENT  
BETWEEN POUR OR  
AS SPECIFIED

NUDURA 12" (305mm)  
STANDARD FORM UNIT

CEILING FINISH AS PER STEEL  
JOIST MANUFACTURERS  
SPECIFICATION (NOTE: WHERE  
GYPSUM BOARD IS REQUIRED TO  
COMPLETE FIRE RATED ASSEMBLY,  
EPS FOAM KERF CUT TO ENABLE  
CEILING FINISH TO PROVIDE  
THERMAL BARRIER CONTACT TO  
CONCRETE)

1/2" (13mm) GYPSUM BOARD

The architecture, engineering, and design of the project using the Nudura products are the responsibility of the project's design professional. All products and systems must comply with local building codes and standards. This detail is for general information and guidance only and Nudura specifically disclaims any liability for the use of this detail. The project design professional determines, in its sole discretion, whether this detail or a functionally equivalent detail is best suited for the project. This detail is subject to change without notice. Contact Nudura to ensure you have the most recent version.

**Non-Combustible Construction**

Detail: Nudura 12" (305mm) Form Unit, Steel Joist Roof System, Non-Bearing Demising Wall			File Name:
Drawn by: KS	Scale: 1 : 8	Date: 12/10/2021	G12B04
<small>tremcocpg.com</small>			

